

# 161 PURDUE AVENUE, KENSINGTON

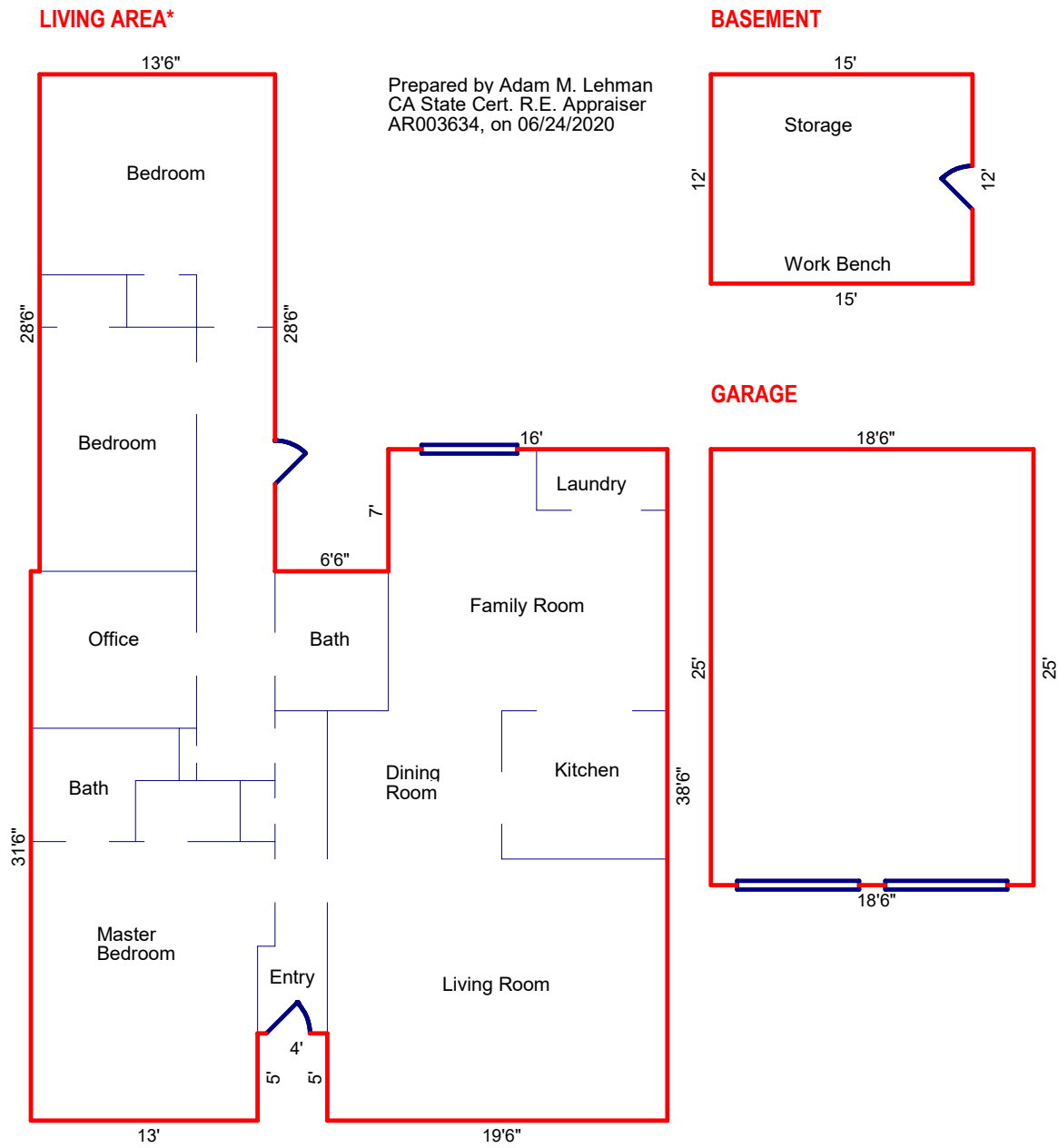

LIVING AREA*	BASEMENT	GARAGE	
0.5 x 31.5 = 15.75	12 x 15 = 180 SF	18.5 x 25 = 462.5 SF	
12.5 x 60 = 750			
1 x 55 = 55			
3 x 26.5 = 79.5			
3.5 x 31.5 = 110.25			
16 x 38.5 = 616			
Subtotal* 1626.5 SF		* Total G.L.A. 1626.5 SF	
Total* 1626.5 SF		Total OTHER 642.5 SF	